

PART NUMBER	DESCRIPTION	Material
HD-SPEAR 1.75x40	HYDRA SPEAR, 40" L x 1-3/4" OD	PURCHASED "FORGED"
HD-SNAP PIN 2.75	SNAP PIN 3/8 x 2-3/4	

	REVISIONS		
REV.	DESCRIPTION	DATE	APPROVED
A	INITIAL RELEASE	7/22/2013	

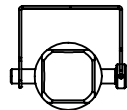
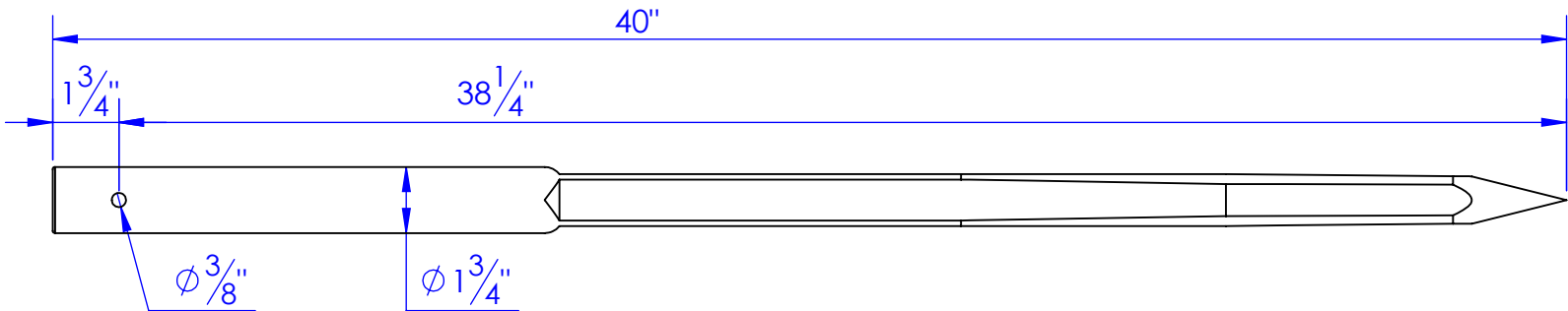
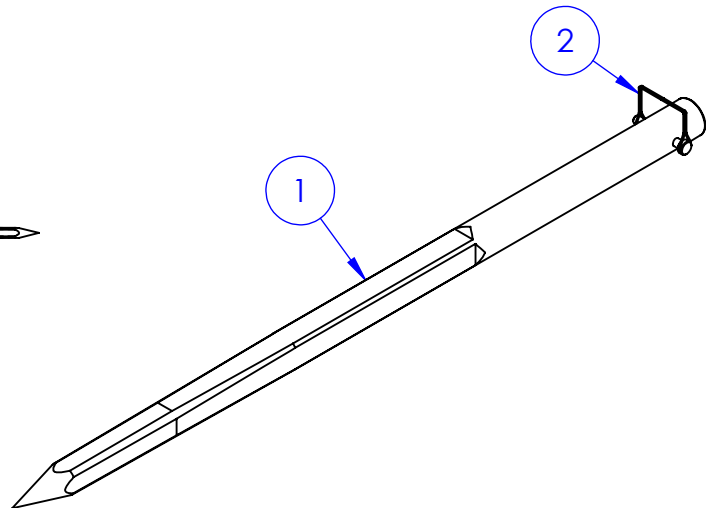
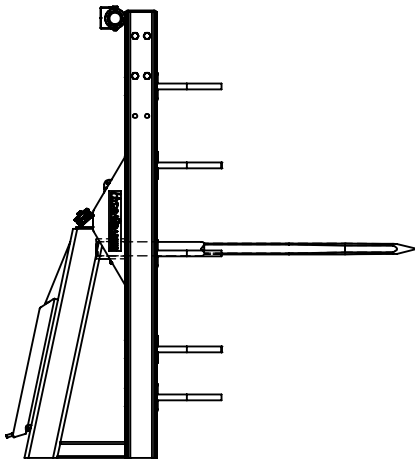
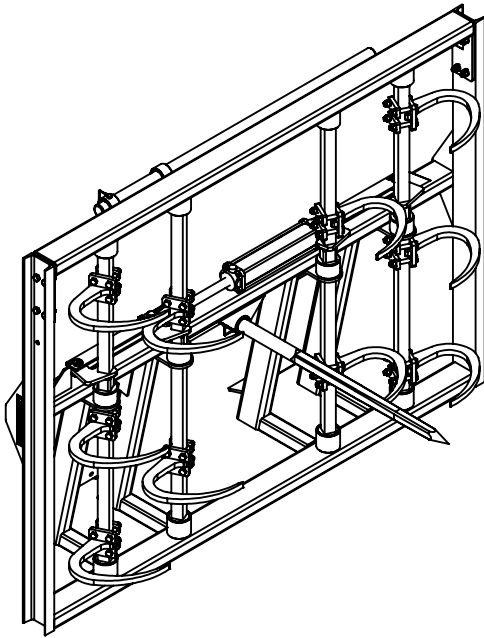

PROPRIETARY AND CONFIDENTIAL
THE INFORMATION CONTAINED IN THIS
DRAWING IS THE SOLE PROPERTY OF TRIPLE
C INC. ANY REPRODUCTION IN PART OR
AS A WHOLE WITHOUT THE WRITTEN
PERMISSION OF TRIPLE C INC. IS PROHIBITED.

DIMENSIONS ARE IN INCHES
TOLERANCES:
FRACTIONAL $\pm 1/16$
ANGULAR: MACH ± 1 BEND \pm
TWO PLACE DECIMAL ± 010
THREE PLACE DECIMAL ± 005

MATERIAL --
DO NOT SCALE DRAWING

NAME	DATE
DRAWN HEATH	7/22/2013
PART #	OP-GR-SPEAR-40
ASM #	

COMMENTS:
HYDRA GRABBER 1-
3/4x40" SPEAR

P.O. BOX 248,
SABETHA, KS 66534

TRIPLE C INC.

SIZE A	DWG. NO. 50-1206	REV. A
SCALE: 1:5	WEIGHT: 21.63	SHEET 1 OF 1